

The Tornado is an ideal counter for outdoor promotional use, with a hollow moulded top and base making it very light and easy to transport. The top includes a pen recess and water drainage notches. The base can be filled with water or sand for added weight and stability, making it suitable for all weather conditions.

### features & benefits

- Suitable for indoor or outdoor use
- Constructed from moulded NDPE and PVC tambour
- Moulded top has a pen recess and water drainage notches
- Weatherproof, robust and durable
- Hollow base for water or sand weighting
- Plain white PVC tambour wrap included
- Header & support poles are an extra cost option



Either Open knee hole or full wrap configurations can be achieved with the same components.

| hardware specifications  | graphic specifications                  | additional info  |
|--|---|--|
| <p>Assembled dimensions (mm)<br/>1040 (h) x 850 (w) x 500 (d) approx.</p> <p>PVC wrap actual dimensions (mm):<br/>900 (h) x 2070 (w) (+/- 5mm)</p> <p>Header assembled dimensions (mm):<br/>250 (h) x 600 (w) approx.</p> <p>Weight:<br/>11.5kg approx</p> <p>Water capacity<br/>Each base holds 25 Litres</p> | <p>Please refer to Graphic template</p> | <p>Included in kit:<br/>Base, top, 4 x screws, 4 x poles,<br/>PVC tambour wrap</p> <p>Printing:<br/>PVC wrap can be printed directly<br/>onto using flat bed printers.</p> |

We are continually improving and modifying our product range and reserve the right to vary the specifications without prior notice. All dimensions and weights quoted are approximate and we accept no responsibility for variance. E&OE.

# Assembly Instructions

## Counter assembly



Kit includes: 4 x poles, 4 x screws, 1 x top, 1 x base, 1 x PVC tambour wrap.

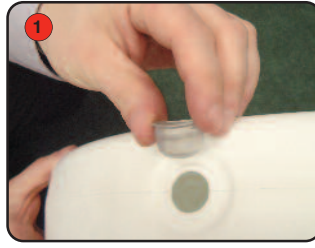

Take the base with the plug hole and fill with water or sand weighting agent. **Important:** make sure the ridge of the bung is on the outside

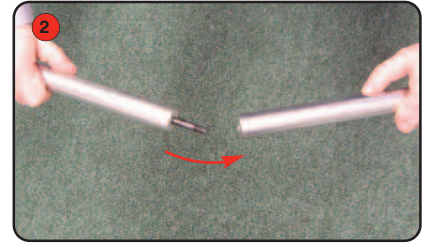

Screw fasten male pole onto female pole. Repeat for remaining poles.



Fit pole assembly through hole in the base and push one of the screws through from the opposite side. Ensure the pole and screw are securely fastened together.



Repeat step 3 for the other pole and then place the base on the floor.



Take the tambour wrap and insert the bottom edge into the grooved guide on the base. Ensure the tambour is fitting securely into the groove.

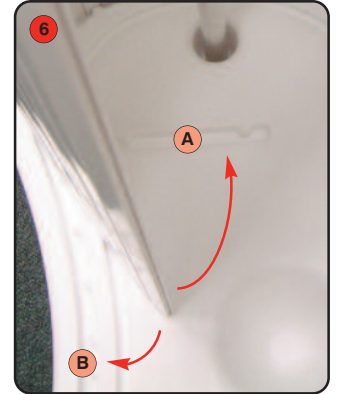

The end of the tambour wrap can slot into groove **A** for a knee hole open style counter or groove **B** for full wrap style counter.



Kneehole style counter



Full wrap style counter



Take the top and align the holes over the poles.



Slot the screw through the top into the pole and secure.