



1. Twist'n'Lock male post onto base



2. Twist'n'Lock female post onto male post



3. Assembled post

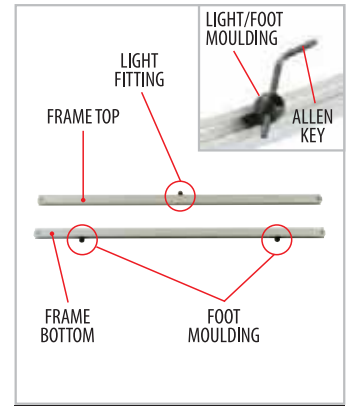

4. Position light fitting and foot mouldings

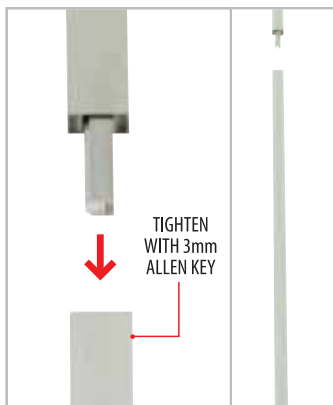

5. Join vertical frame sections



6. Attach horizontal frame sections

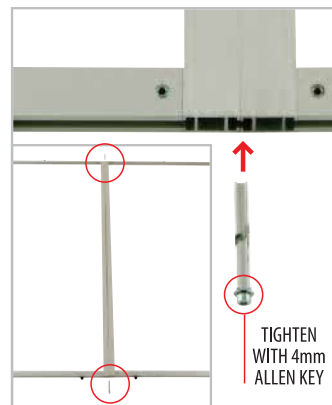

7. Join frames together [not necessary for 1 frame kit]

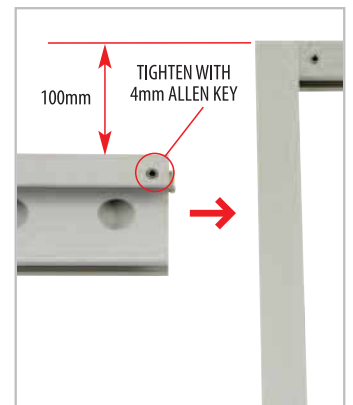

8. Attach top left post-to-frame joiner

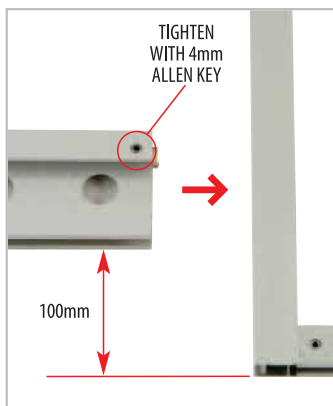

9. Attach bottom left post-to-frame joiner

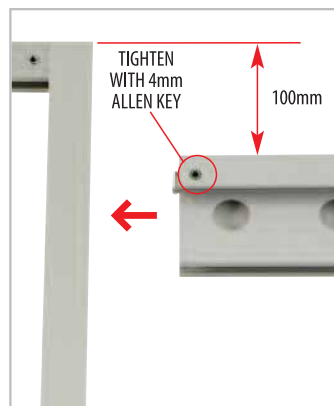

10. Attach top right post-to-frame joiner

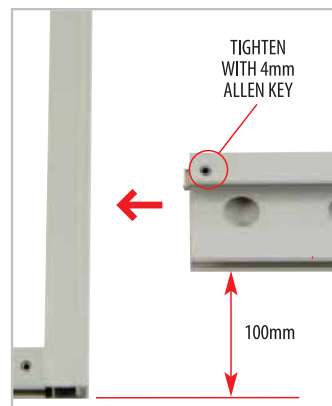

11. Attach bottom right post-to-frame joiner

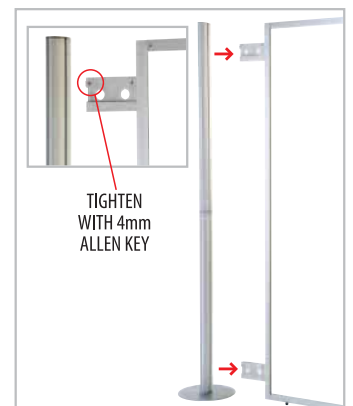

12. Join post onto post-to-frame joiner

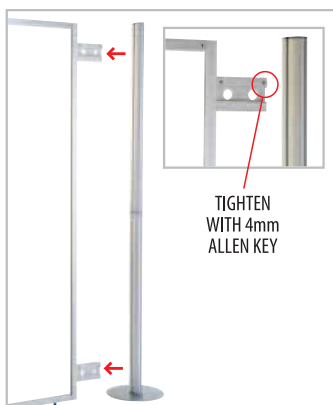

13. Join post onto post-to-frame joiner



14. Attach panels to complete a two frame Versa straight kit with flexible panels

Two frame straight kit illustrated, for every additional frame repeat steps 4-7.

IMPORTANT NOTE:

All Allen key fixings need to be positioned to the rear of the kit. Graphic panels are attached to the front of the Versa kit. Where stated use either 3 or 4mm Allen key to tighten locking mechanism.